

Aspen Vista® Collar Sizing Guide

APPLICATION

Position The Collar Front

Position the Vista collar front in the middle of the chest and slide up the sternum until the collar chin piece is cradling the patient's chin.

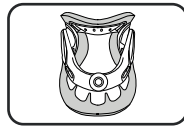

Adjust Height

Place the dial of the collar at or below the sternal notch and adjust the dial clockwise until the collar reaches the chin. NOTE: the dial has to be distracted from the collar before it can be rotated.

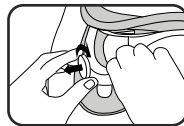

Tighten

With cervical neutral being maintained, mate hook and loop on both sides of the collar. If additional tightening is required, apply downward pressure on either side of the tracheal opening while refastening hook and loop on sides.



CHECK THE FIT

1. Sternal Notch Visible?

When properly positioned, the sternal notch should be visible through the tracheal opening and the chin should be well supported by the chin piece.

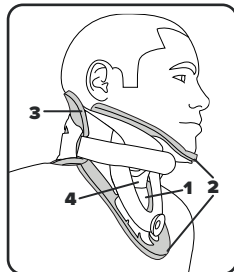

2. Collar Dialed Up?

Make sure there is no gap between the chin piece and chin and between the sternum pad and chest. The chin pad should be slightly compressed.

3. Slack Out?

The collar side panels wrap against and behind the neck while resting on or above the trapezius. Tighten the back panel evenly so it stays centered. If any gaps are present, tighten the collar further.

4. Throat Area Clear?

If the back of the chin piece is seen to be touching the throat, disconnect the hook and loop on both sides and lift the sides of the front panel up and off of the trapezius muscle. This will cause the chin piece to move forward, away from the throat.

Guidelines only. For more detailed information, check the instruction sheet, call to speak to a representative or visit our website at aspennmp.com.

Aspen Vista® Collar Sizing Guide

APPLICATION

Position The Collar Front

Position the Vista collar front in the middle of the chest and slide up the sternum until the collar chin piece is cradling the patient's chin.

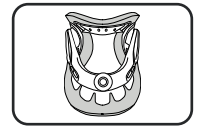

Adjust Height

Place the dial of the collar at or below the sternal notch and adjust the dial clockwise until the collar reaches the chin. NOTE: the dial has to be distracted from the collar before it can be rotated.

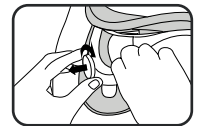

Tighten

With cervical neutral being maintained, mate hook and loop on both sides of the collar. If additional tightening is required, apply downward pressure on either side of the tracheal opening while refastening hook and loop on sides.



CHECK THE FIT

1. Sternal Notch Visible?

When properly positioned, the sternal notch should be visible through the tracheal opening and the chin should be well supported by the chin piece.

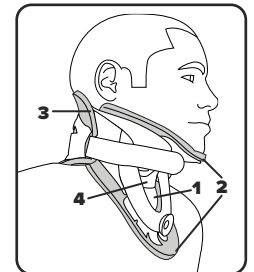

2. Collar Dialed Up?

Make sure there is no gap between the chin piece and chin and between the sternum pad and chest. The chin pad should be slightly compressed.

3. Slack Out?

The collar side panels wrap against and behind the neck while resting on or above the trapezius. Tighten the back panel evenly so it stays centered. If any gaps are present, tighten the collar further.

4. Throat Area Clear?

If the back of the chin piece is seen to be touching the throat, disconnect the hook and loop on both sides and lift the sides of the front panel up and off of the trapezius muscle. This will cause the chin piece to move forward, away from the throat.

Guidelines only. For more detailed information, check the instruction sheet, call to speak to a representative or visit our website at aspennmp.com.

Aspen® Pediatric Line Sizing Guide

A PROPER FIT AS EASY AS 1-2-3

1. Chin-Dots hidden?

The chin must be flush with the front of the chin piece plastic.





2. Hook and Loop past mark?

Back panel plastic must overlap the sides of the front panel.

3. FlexTabs™ bent?

The FlexTabs on the front and back panels should be flexed.

SIZING GUIDELINES

PD 1		1 - 18 months weight 11 - 29 lbs (5 - 13 kg) length 21 - 33 in (53 - 84 cm)
PD 2		9 - 24 months weight 22 - 33 lbs (10 - 15 kg) length 29 - 37 in (74 - 94 cm)
PD 3		1 - 3 years weight 24 - 36 lbs (11 - 16 kg) length 33 - 40 in (84 - 102 cm)
PD 4		2 - 5 years weight 26 - 42 lbs (12 - 19 kg) length 35 - 45 in (89 - 114 cm)
PD 5		3 - 6 years weight 27 - 54 lbs (12 - 25 kg) length 37 - 48 in (94 - 122 cm)

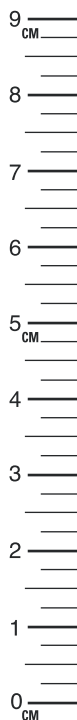

Life Changing Innovation

Please Refer to Pediatric Collar Instruction Sheet for More Information.

© 2021 Aspen Medical Products, LLC • aspenmp.com
800-295-2776 • 949-681-0200 • LIT5056D 04/21

Aspen® Pediatric Line Sizing Guide

A PROPER FIT AS EASY AS 1-2-3

1. Chin-Dots hidden?

The chin must be flush with the front of the chin piece plastic.





2. Hook and Loop past mark?

Back panel plastic must overlap the sides of the front panel.

3. FlexTabs™ bent?

The FlexTabs on the front and back panels should be flexed.

SIZING GUIDELINES

PD 1		1 - 18 months weight 11 - 29 lbs (5 - 13 kg) length 21 - 33 in (53 - 84 cm)
PD 2		9 - 24 months weight 22 - 33 lbs (10 - 15 kg) length 29 - 37 in (74 - 94 cm)
PD 3		1 - 3 years weight 24 - 36 lbs (11 - 16 kg) length 33 - 40 in (84 - 102 cm)
PD 4		2 - 5 years weight 26 - 42 lbs (12 - 19 kg) length 35 - 45 in (89 - 114 cm)
PD 5		3 - 6 years weight 27 - 54 lbs (12 - 25 kg) length 37 - 48 in (94 - 122 cm)



Life Changing Innovation

Please Refer to Pediatric Collar Instruction Sheet for More Information.

© 2021 Aspen Medical Products, LLC • aspenmp.com
800-295-2776 • 949-681-0200 • LIT5056D 04/21